



# R.A.K. BATHWARE



## Diana Above Counter Basin

### FEATURES

- ▶ 420mm without overflow
- ▶ 0 tap hole
- ▶ White only

### WARRANTY

- ▶ Vitreous China: 10 year

### VOLUME

- ▶ 10 Litres

[www.rakbathware.com.au](http://www.rakbathware.com.au) 1300 661 727

**Tap, overflow ring & pop up waste is not included**

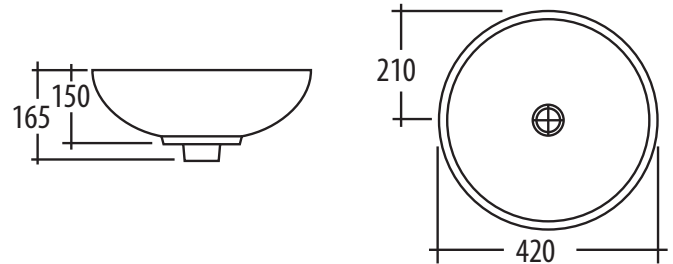

### Installation Note:

Flexible sealant must be used to install basin.

\* Tolerance:  $\pm 3\%$  on dimensions below 200mm &  $\pm 5\%$  for dimensions above 200mm  
All Measurements relate to finish floor or finish wall measurements.  
All information shown are correct at time of printing .09/03/2015.  
RAK Bathware recommends, that prior to installation all technical specifications be confirmed with current tech specs on our website [www.rakbathware.com.au](http://www.rakbathware.com.au)



Water Mark  
AS / NZS 1730  
Lic. SMK01986  
Standards Australia  
MADE IN U.A.E.

